



# INSTALLATION INSTRUCTIONS



## 1. Ideal installation conditions:

The sub floor must be well leveled.

The sub floor must be cleaned of dust, grease, paint or other materials that reduce the stickiness of adhesives to use

## 2. Necessary tools

snap-off knife, pencil, measuring tape, ruler, paint roller, paint tray, bucket



## 3. Atmosphere conditions of Storage and Installation

Temperature between 15°C and 25°C (59°F to 77°F)

Humidity/ moisture between 45% and 65%

Store rolls vertically on-site 48 hours prior to installation

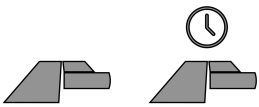

## 4. Unroll the rolls

After unrolling, wait a few minutes until cork returns to its flat shape



## 5. Make a marking with a pencil on the Sub-floor

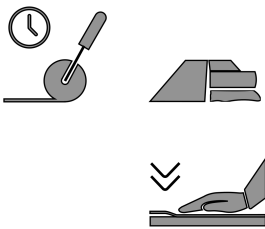

## 6. Gluing

Lift half the roll length and apply glue, approximately 300g / m<sup>2</sup>

Glue the Corkoleum roll where it has already glue after ± 20 minutes

Lift the unglued Corkoleum roll and apply Glue

Glue the Corkoleum roll after ± 20 minutes

Use your hands to remove all air bubbles that can appear during bonding

### 6.1. Gluing Scheme



## 7. Clean all installation waste

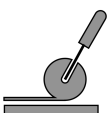

## 8. Finishing

A finish coating should be applied 24 hours after floor instalation

Apply varnish according to manufacturer's instructions

### 8.1. Finishing application Scheme

Apply the varnish crosswise (one horizontally and one vertically) thus, the second pass will cover any failure of the first pass

